

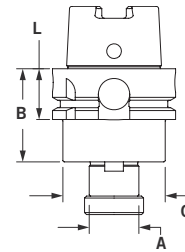

HSK63A Facemill Holders



- Pilot diameter is sized for precision fit with cutter
- Face perpendicular to center line within .0002"
- Removable/replaceable drive keys are standard
- Fine thread locking screw is included
- Less tool wear and replacement means less scrap



| HSK63A Facemill Holders | | | | | |
|--------------------------------|--------|-----------------|------|------|----------------------------------|
| Taper | Size A | Gage Length (B) | C | L | Part # |
| HSK63A | 3/4 | 1.75 | 1.69 | 1.02 | RHSK63ASM0750175 |
| HSK63A | 3/4 | 4.00 | 1.69 | 1.02 | RHSK63ASM0750400 |
| HSK63A | 1 | 1.88 | 2.06 | 1.02 | RHSK63ASM1000188 |
| HSK63A | 1 | 4.00 | 2.06 | 1.02 | RHSK63ASM1000400 |
| HSK63A | 1-1/4 | 2.50 | 2.75 | 1.02 | RHSK63ASM1250250 |
| HSK63A | 1-1/4 | 4.00 | 2.75 | 1.02 | RHSK63ASM1250400 |
| HSK63A | 1-1/2 | 2.75 | 3.81 | 1.02 | RHSK63ASM1500275 |
| HSK63A | 1-1/2 | 4.00 | 3.81 | 1.02 | RHSK63ASM1500400 |

| Facemill Holder Replacement Lock Screws | | | | | | | |
|--|--------|--------|------|-----|-------|------------|---------------------------|
| Holder Size | Size A | B | C | D | Photo | Dimensions | Part # |
| 3/4 | .875 | 3/8-24 | .63 | .37 | | | RSMLS0750 |
| 1 | 1.188 | 1/2-20 | .81 | .37 | | | RSMLS1000 |
| 1-1/4 | 1.500 | 5/8-18 | .94 | .50 | | | RSMLS1250 |
| 1-1/2 | 1.875 | 3/4-16 | 1.13 | .50 | | | RSMLS1500 |

| Facemill Holder Replacement Drive Keys | | | | | |
|---|--------|------|-------|------------|---------------------------|
| Holder Size | Size A | B | Photo | Dimensions | Part # |
| 3/4 | 5/16 | 5/32 | | | RSMDK0750 |
| 1 | 3/8 | 3/16 | | | RSMDK1000 |
| 1-1/4 | 1/2 | 1/4 | | | RSMDK1250 |
| 1-1/2 | 5/8 | 5/16 | | | RSMDK1500 |

Note: Drive keys are in line with drive slot.

| HSK63A Coolant Accessories | | |
|-----------------------------------|---------------------------|----------------------------|
| HSK63A Coolant Tube | HSK63A Coolant Tube Plug | HSK63A Coolant Tube Wrench |
| | | |
| RHSK63ACT | RHSK63AHP | RHSK63ATW |